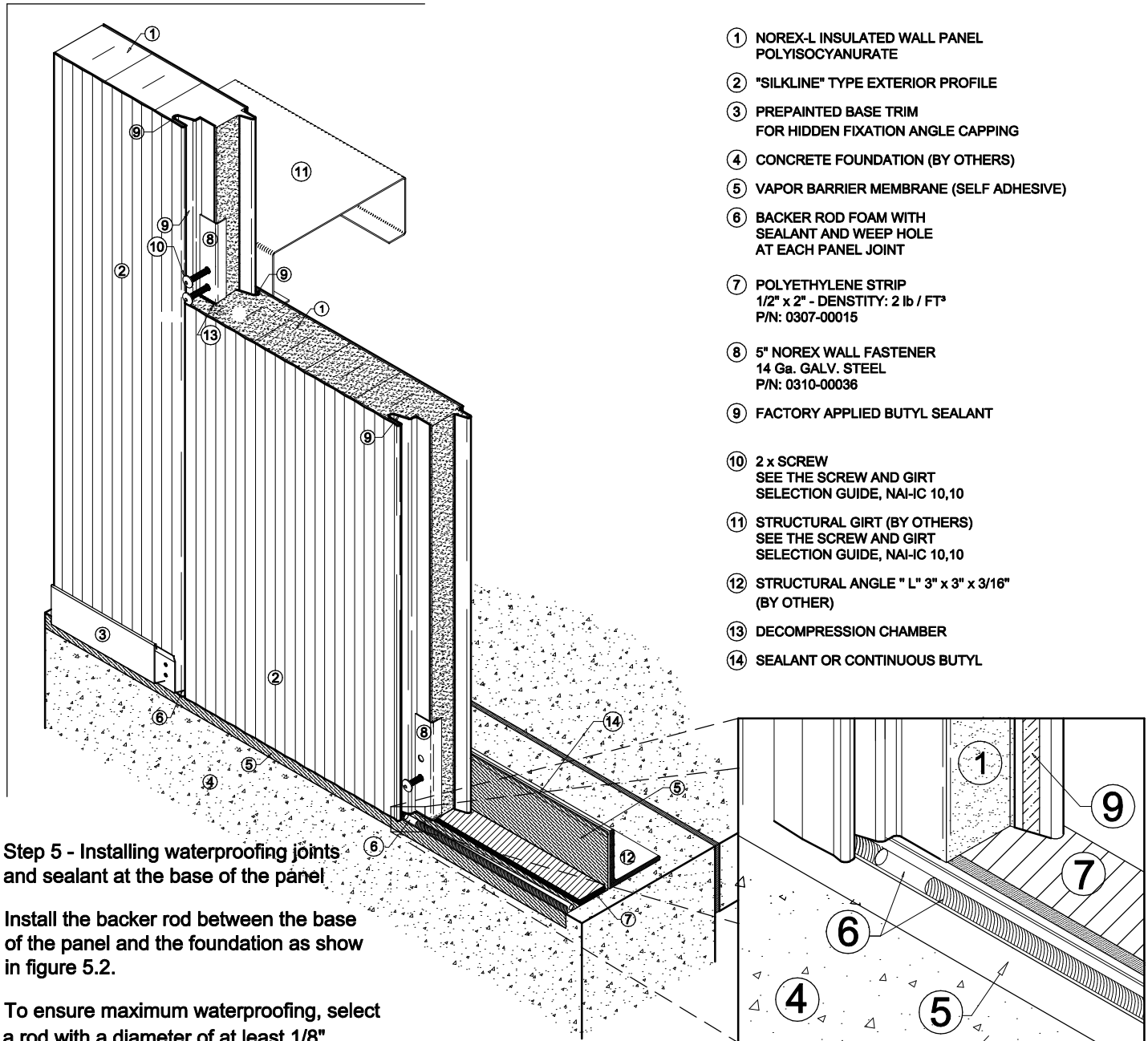

Figure 5.1: Typical Assembly



- ① NOREX-L INSULATED WALL PANEL  
POLYISOCYANURATE
- ② "SILKLINE" TYPE EXTERIOR PROFILE
- ③ PREPAINTED BASE TRIM  
FOR HIDDEN FIXATION ANGLE CAPPING
- ④ CONCRETE FOUNDATION (BY OTHERS)
- ⑤ VAPOR BARRIER MEMBRANE (SELF ADHESIVE)
- ⑥ BACKER ROD FOAM WITH  
SEALANT AND WEEP HOLE  
AT EACH PANEL JOINT
- ⑦ POLYETHYLENE STRIP  
1/2" x 2" - DENSITY: 2 lb / FT<sup>3</sup>  
P/N: 0307-00015
- ⑧ 5" NOREX WALL FASTENER  
14 Ga. GALV. STEEL  
P/N: 0310-00036
- ⑨ FACTORY APPLIED BUTYL SEALANT
- ⑩ 2 x SCREW  
SEE THE SCREW AND GIRT  
SELECTION GUIDE, NA-IC 10,10
- ⑪ STRUCTURAL GIRT (BY OTHERS)  
SEE THE SCREW AND GIRT  
SELECTION GUIDE, NA-IC 10,10
- ⑫ STRUCTURAL ANGLE " L " 3" x 3" x 3/16"  
(BY OTHER)
- ⑬ DECOMPRESSION CHAMBER
- ⑭ SEALANT OR CONTINUOUS BUTYL

**Step 5 - Installing waterproofing joints and sealant at the base of the panel**

Install the backer rod between the base of the panel and the foundation as show in figure 5.2.

To ensure maximum waterproofing, select a rod with a diameter of at least 1/8" greater than the space to be sealed, manufacturers of such products generally recommend a 30% to 50% compression rate.

Leave a 1" opening (weep hole) at the base of each panel section.

Apply sealant evenly over the backer rod, when specified.



NOTE: ANY DESIGN CHANGE TO THE CLIP, THE JOINT, THE FASTENING METHOD OR THE INSULATION PROPERTIES MUST BE COMMUNICATED TO FM FOR APPROVAL.